

Waldorf Bed Parts List

PART #895703 HARDWARE BAG FOR FRAME MOUNTING (BED)

- 1 (4) 1/4-20 2 3/4" ALLEN HEAD SCREW
- 2 (4) 1/4-20 1" ALLEN HEAD SCREW
- 3 (8) METAL WASHERS 1/4"(ID)
- 4 (4) 1/4-20 HEX NUTS
- 5 (1) ALLEN WRENCH 4 mm
- 6 (8) RUBBER WASHER
- 13 (4) PLASTIC GLIDE UNIVERSAL #150970000

PART #2058 HARDWARE BAG FOR FRAME MOUNTING (HDBD)

- 1 (4) 1/4-20 2 3/4" ALLEN HEAD SCREW
- 3 (4) METAL WASHERS 1/4"(ID)
- 4 (4) 1/4-20 HEX NUTS
- 5 (1) ALLEN WRENCH 4 mm
- 6 (4) RUBBER WASHER
- 13 (2) PLASTIC GLIDE UNIVERSAL #150970000

(7) PART #89570474 FOOT CONNECTOR AGED BRASS OR
PART #89570401 FOOT CONNECTOR ANT. PLATINUM

(10) PART #100574 LEG EXT. AGED BRASS OR
PART #100501 LEG EXT. ANT. PLATINUM

(14) PART #89570374 FINIAL AGED BRASS OR
PART #89570301 FINIAL ANT. PLATINUM

Fashion Bed Group

A Division of Leggett & Platt Incorporated

Instruction Sheet

SAVE ALL PACKAGING MATERIALS UNTIL PRODUCT IS FULLY ASSEMBLED. HARDWARE AND SMALL PIECES MAY NOT BE SEEN AND BE ACCIDENTALLY DISCARDED WITH PACKAGING MATERIALS.

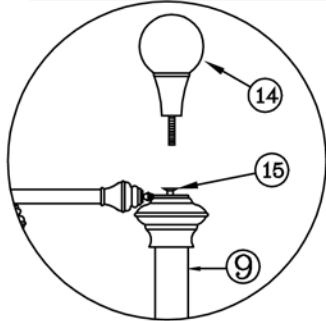

To Attach Finial to Headboard & Footboard Posts

Before you screw in finial (14) to post (9), you need to remove screw (15) and discard. Now you are ready to screw in finial. Do the same for the other posts.

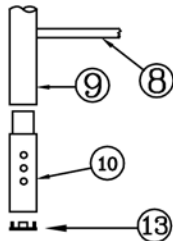

To Attach Extension Legs to Headboard

Carefully insert extension legs (10) into bottom of post (9) making sure the 3 holes on extension legs are perpendicular to the grill (8). Insert plastic glide (13) leg extensions (10).

To Attach Headboard to Frame

Using screws, washers, and nuts which are included in hardware kit, insert screws (1) thru aligned holes on post (9) and frame (11), place a rubber washer (6) between post and frame. Attach washers (3) with nuts (4) and tighten.

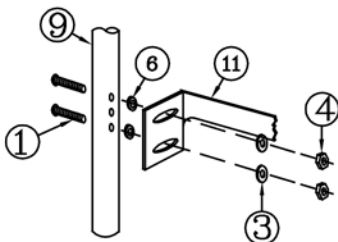

To Attach Footboard Connector to Footboard post

Insert plastic glide (13) with foot connector (7) into bottom of footboard pos. Do the same in other post. (TO FIRMLY INSERT GLIDE, YOU MAY NEED TO USE A PADDED HAMMER).

NOTE: If you have aduo version follow this instructions to assemble foot connector.

To Attach Footboard to Frame

Remove screws (2) and washers (3) from footboard posts. NOTE: If washers and screws are not in footboard posts, they can be found in a bag in the leg extension carton. Align holes in posts with holes in frame brackets (11). Place a rubber washer (6) between post and frame brackets. Insert screw (2) thru washer (3) and frame bracket into post (9). Repeat on other post. Tighten all connections.

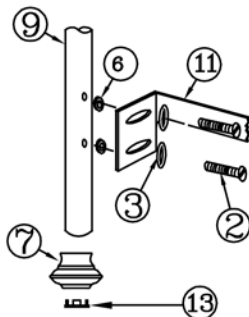

Duo Panel Version

NOTE: There are two sets of leg.ext. The longer one is for headboard and the shorter one is for footboard.

To assemble follow steps above.